

Interpet

# Insight LED

Auto feeder

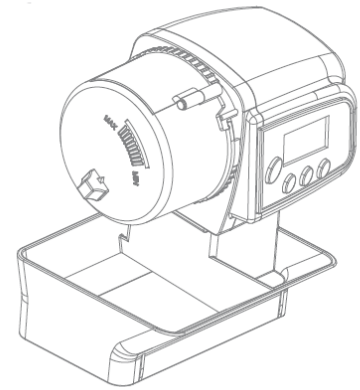

## Button Description

**MODE Button:** Local time and feeding time are set by this button.

**SET Button:** After pressing the MODE button, the SET button allows the respectively displayed times to be changed.

**ADJUST Button:** After pressing the SET button, the respectively effected symbol (either time or feeding mode) blinks and can be set to a higher number.

**ONE TOUCH FEED BUTTON:** Automatically rotates the roller once for a single manual feeding.

FIG 1

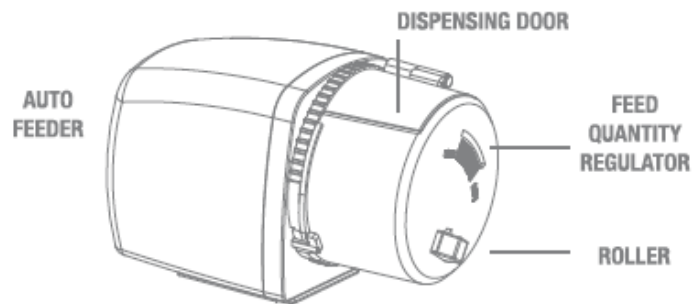

FIG 2

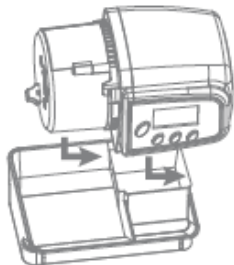
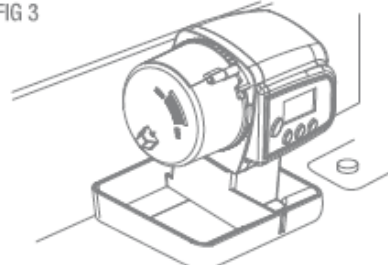

FIG 3



## Feeder Installation

a. Open battery cover and install two AAA (1.5V) batteries. If the symbol LO appears on the display the batteries installed need to be replaced.

b. Adjust feed quantity regulator to the maximum setting. Slide roller off feeder (FIG 1) and fill with flake or pelleted fish food. Slide roller back onto feeder and close quantity regulator.

c. When refilling roller, be sure it is cleaned before refilling with new food. This will help prevent food spoilage.

d. Using the fish food hopper (FIG 2), slide fit the feeder onto the hopper sideways until it becomes a tight fit.

e. The feeder can then be push fit into place on top of the feeding hole on the underside of the feeding flap (FIG 3) (be careful not to open the aquarium hood while the feeder is in position).

## Programming the timer

### a. SETTING THE CLOCK

Press SET button once and hours will blink. Press the ADJUST button to set hour time. Press MODE and minutes will blink. Press the ADJUST button to set minutes. Press SET again and the current time will be displayed. The timer operates on a 24hr cycle, therefore 5pm = 1700hrs.

### b. SETTING THE FEEDER TIME

Press the MODE button, 0:00 will be displayed. Press the SET button, hours blink. Press the ADJUST button to program hour of first feeding time. Press the MODE button, minutes will blink. Press the ADJUST button to program the minutes of first feeding time. Press MODE again and the '1' digit will flash. Press ADJUST once and a single arrow appears by the '1↓' to indicate a single feed at this programmed interval. Press ADJUST again if a double feed is required at this interval a second arrow appears '1↓↓'. Each feeding will be separated by a 60 second interval. Press SET again and first feeding interval program will be complete.

### c. PROGRAMMING ADDITIONAL FEEDINGS

Repeat steps above for programming additional feedings. The feeder can be programmed for upto 4 times daily.

### d. DELETING A FEEDING PROGRAMME

Press MODE program to find program that will be deleted. Press SET to select the program. Press MODE twice and the number of the program will blink. Press ADJUST to delete the program. Press SET to confirm deletion.

### e. MANUAL OPERATION

Press ONE TOUCH FEED BUTTON, feeder will automatically dispense one feeding. To reset feeder, remove batteries and wait 1 minute. Replace batteries.

## Adjusting feed amount

a. By adjusting the feed quantity regulator the amount of food dispensed at each feeding can be set. Simply adjust the quantity regulator (FIG 1) to desired setting and press the ONE TOUCH FEED button to measure how much feed will be dispensed in one feeding. Adjust quantity regulator as desired.

**Note:** As a general rule, aquarium fish only need to be fed twice a day. Feed only the amount of food the fish consume 5-10 seconds. Over feeding can cause cloudiness, ammonia problems and can create a deadly imbalance in an aquarium tank.

## Guarantee

This product is guaranteed against defects in material and workmanship for 12 months from the date of purchase, under normal usage.

The GUARANTEE DOES NOT APPLY in case of improper use, negligence, lack of maintenance or accidental damage. If the auto feeder fails due to a manufacturing fault within this period it will either be replaced free of charge or repaired. Liability is limited to replacement of the faulty product only no other costs will be reimbursed.

This guarantee is not transferable and does not affect your statutory rights. This guarantee does not confer any rights other than those expressly set out above.



You can help protect the environment. Please remember to respect the local regulations: hand in non-working electrical equipment to an appropriate waste disposal centre.

## Consumer Advice contact details

Interpet Ltd.

Consumer Advice Department

Vincent Lane, Dorking, Surrey RH4 3YX

Fax: 01306 876712

E-mail: [customercare@interpet.co.uk](mailto:customercare@interpet.co.uk)

[www.interpet.co.uk](http://www.interpet.co.uk)