

# Nano DELTAMINI heater

## How to install your nano Deltamini heater

**a.** The plug in power supply is not waterproof – this must be mounted so that it cannot fall into the aquarium. The mains cable must be installed with a drip loop to prevent any water running down the cable into the plug socket (see image below). Do not operate the heater in an aquarium near or under an air conditioning unit, in direct sunlight, near a heat source or under a light source which is on for extended periods of time.

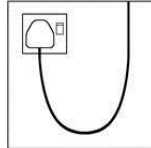

**b.** The Deltamini heater is designed to fit in a variety of ways inside the aquarium, ensure the heater is fully submerged up to the power cord at all times when in use:

- The flat design enables the heater to be installed on the side of the aquarium using the suction cup provided; this ensures it cannot fall out of the aquarium while in use (images 1 and 4 below).
- It can also be tucked away into the filter section of most small aquariums, again use the suction cup provided to ensure it stays in position (image 2 and 4 below).
- Or it can be buried in any type of aquarium substrate for permanent use in the aquarium (see image 3 below). It is important to keep the Deltamini away from direct contact to the aquarium base to avoid damage.

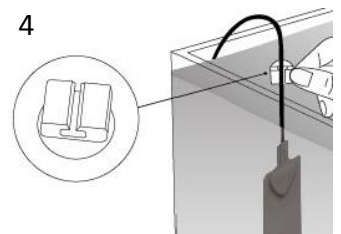

**Top Tip:** Before removing the heater from the aquarium, always turn off the power and let it cool down for approximately 5 minutes.

**c.** The Deltamini is designed so that it constantly produces a set amount of heat into the aquarium, it is not thermostatically controlled so the room and water temperature have to be closely monitored during the warmer seasonal periods. Use the aquarium thermometer included to monitor the water temperature.

### Deltamini 7.5w (Up to 12 litre Aquariums)

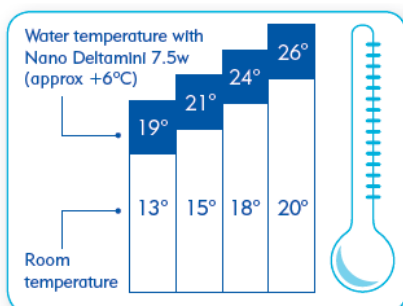

### Deltamini 15w (Up to 20 litre Aquariums)

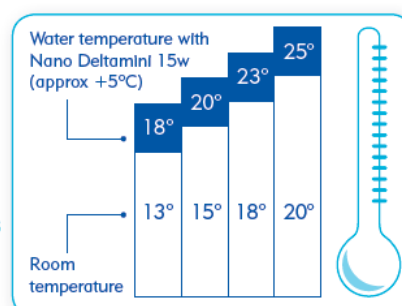

Top Tip: if the room ambient temperature rises above 24 degrees, turn off power to the Deltamini until the room ambient temperature returns to a temperature of 24 degrees Celsius or less.

### Maintenance

- Once a year if the Deltamini is not buried in the substrate, switch off and remove from the aquarium – wipe of any dirt, algae or mineral deposits around the heat pad with a damp cloth. Do not use cleaning agents that could enter the aquarium and harm your livestock.
- The suction cup will eventually lose its suction, when this happens it should be replaced, see Interpet spare codes below.

Top tip: to optimise adhesion clean the glass before applying the suction cup.

### Spares

Product Spare	Code
7.5w and 15w Deltamini suction cup	1692

### Important information

- This unit is for indoor use only – do not use outside.
- Do not use this unit if the cable or plug are damaged or appear to be malfunctioning.
- Do not use this unit if the plug gets wet.
- Dispose of responsibly following instructions from your local authority.
- Do not position so that it comes into long-term contact with the aquarium base or sides as this could lead to damage to the aquarium.

### Guarantee

This product is guaranteed against defects in material and workmanship for 12 months from the date of purchase, under normal usage.

The GUARANTEE DOES NOT APPLY in case of improper use, negligence, lack of maintenance or accidental damage. This guarantee does not cover the suction cup which is a replaceable part (see spares above.) If the heater fails due to a manufacturing fault within this period it will either be replaced free of charge or repaired. Liability is limited to replacement of the faulty product only no other costs will be reimbursed.

This guarantee is not transferable and does not affect your statutory rights. This guarantee does not confer any rights other than those expressly set out above.



You can help protect the environment. Please remember to respect the local regulations: hand in non-working electrical equipment to an appropriate waste disposal centre.

### Consumer Advice contact details

Interpet Ltd.

Consumer Advice Department

Vincent Lane, Dorking, Surrey RH4 3YX

Fax: 01306 876712 E-mail: [customercare@interpet.co.uk](mailto:customercare@interpet.co.uk)

[www.interpet.co.uk](http://www.interpet.co.uk)