

# 1. WHY DO I NEED AN AQUARIUM FILTER?

Aquariums are a closed system and any waste or dirt produced by fish and plants remains in the water. A filter acts like a waste processing plant:

- Trapping dirt and removing dyes for crystal clear water
- Processing fish waste to create a healthy environment
- Circulating and aerating water to maximise oxygenation

## EFFECTIVE FIVE STAGE FILTRATION:

- 1. Bio-Media** – creates healthy water by acting as a home for essential bacteria which remove toxic fish waste.
- 2. Mechanical Floss** – clears water by trapping finer waste.
- 3. Mechanical Sponge** – black sponge traps large waste.
- 4. Carbon** – Purifies water by removing dyes, toxins, heavy metals and odours.
- 5. Oxygenated** – built in venturi injects tiny bubbles returning clear and healthy water into the aquarium.

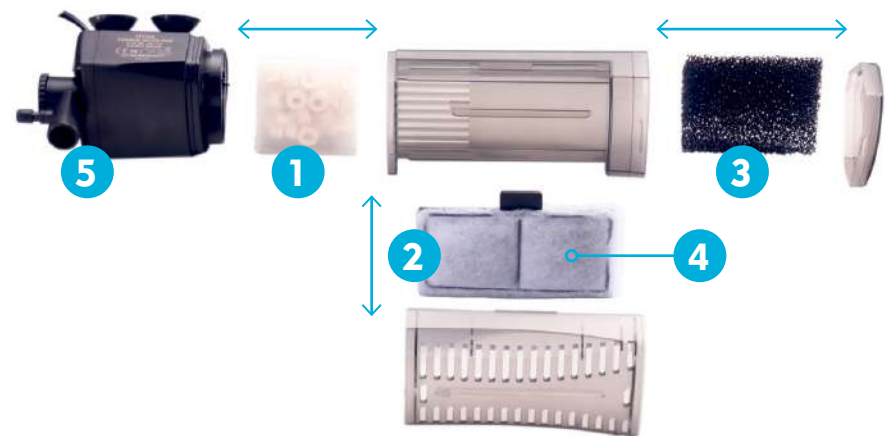

# 2. TECHNICAL SPECIFICATION

Size	Max. Flow Rate		Power	For Aquarium Size	
	L/hr	Gal/hr		Length	Volume
CPF			Watts	cm (inches)	Litres (Gallons)
1	300	65	4.5W	up to 60 (24)	up to 65 (14)
2	400	87	5.5W	up to 80 (31)	66-110 (15-24)
3	600	131	8.5W	up to 100 (40)	111-160 (24-35)

# 3. INSTALLING YOUR CPF 1/2/3 FILTER

## 3 SETUP OPTIONS AVAILABLE

### Option 1 – Nozzle Outlet

- Connect the nozzle outlet to the water outlet of the filter.
- Install the filter into a corner of the aquarium with the suckers.
- Make sure the filter is fully submerged in water.
- Connect the filter to the power supply when safe to do so.
- Adjust the direction of the water flow left or right with the flow direction adjuster and turn the flow adjustment knob to adjust the flow rate.

- Connect the filter to the power supply when safe to do so.
- Adjust the direction of the water flow left or right with the flow direction adjuster and turn the flow adjustment knob to adjust the flow rate. Turn the air flow adjustment knob to adjust the air flow rate.



### Option 2 – Venturi Option

- Connect the wide water outlet to the water outlet of the filter.
- Remove the air inlet stopper from the air inlet, connect the air tubing to the air inlet, then attach the air tubing to the power cord of the filter with the air tubing clip. Make sure the air flow adjuster is placed outside water.
- Install the filter into a corner of the aquarium with the suckers.

### Option 3 – Spray Bar

- Connect the spray bar to the water outlet.
- Install the filter into a corner of the aquarium with the suckers.
- Make sure the spray bar is positioned horizontally and the filter is positioned above the minimum water level.



### WARNING

The air inlet must remain locked (insert the air inlet stopper) when the filter is operated with the spray bar. Otherwise, there is a risk of water spilling out of the air hose.

# 4. MAINTENANCE

The CPF internal filter range has been designed to give high performance with minimal maintenance.

Regular maintenance however, will help to maintain the environment in your aquarium, as well as prolonging the lifespan of both your fish and the filter itself.

Before performing any maintenance ensure the filter has been isolated from the power supply.

### a. Daily Care:

Ensure the filter is working correctly. Check the flow.

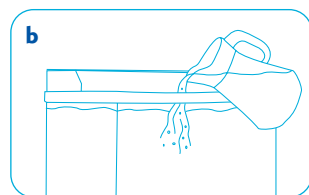

### b. Weekly Care:

Top up aquarium for any evaporation.

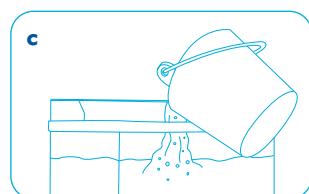

### c. Monthly Care:

Conduct a 25% water change. Clean the foam and ceramic media in water taken from the aquarium. Replace the cartridge.

### d. 3 Monthly Care:

Clean impeller and impeller chamber in freshwater.



### e. Replace the Black Sponge:

Supplied with the three month service pack.



## Important safety information:

To prevent any drips entering the electrical socket, create a drip loop for the filter cable as per the diagram on the right:

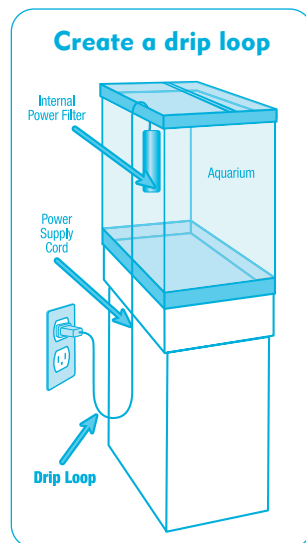

# 5. TOP TIPS FOR A HEALTHY AND SUCCESSFUL AQUARIUM

- 1 Select the correct number and species of fish for a balanced community.
- 2 Care for your water; do recommended water changes, filter cleaning, water testing and take special care when adding new fish.
- 3 Don't rush the early days, start slowly and carefully for long term success.
- 4 Enjoy your aquarium!
- 5 See online for further information on all aspects of keeping an aquarium and fishkeeping at [www.interpet.co.uk](http://www.interpet.co.uk).

If you are starting a new aquarium, go to [www.interpet.co.uk](http://www.interpet.co.uk) for detailed information and support on correctly introducing fish, water changes and testing your water quality.



Interpet has applied over 70 years of aquatic experience to ensure every element of the design of this product has been carefully considered to help you enjoy aquarium keeping.

Email: [customer@interpet.co.uk](mailto:customer@interpet.co.uk)

Distributed by: Interpet Ltd, Vincent Lane, Dorking Surrey RH4 3YX

EU Address: Interpet Europe Ltd, 22 Northumberland Rd, Ballsbridge, Dublin 4, Ireland, D04 ED7

[facebook.com/interpet](https://www.facebook.com/interpet)

[www.interpet.co.uk](http://www.interpet.co.uk)

# GETTING TO KNOW YOUR CPF FILTER

## CPF 1/2/3

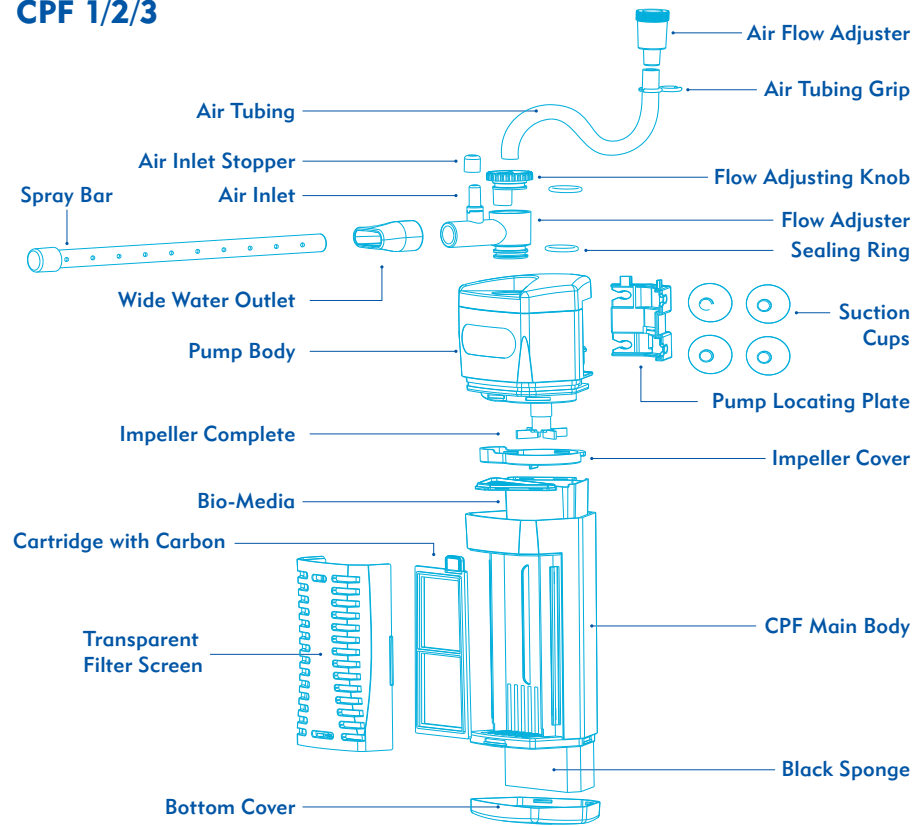

Part:	CPF1	CPF2	CPF3
Air Flow Adjuster	51692	51693	
Air Tubing Grip	51692	51693	
Air Tubing	51692	51693	
Air Inlet Stopper	51692	51693	
Air Inlet	N/A	N/A	N/A
Flow Adjuster	51692	51693	
Spray Bar	51692	51693	
Sealing Ring	51692	51693	
Wide Water Outlet	51692	51693	
Pump Body	N/A	N/A	N/A
Suction Cups	51692	51693	
Pump Locating Plate	51692	51693	
Impeller Complete	51688	51689	51690
Impeller Cover	N/A	N/A	N/A
Bio-Media	N/A	N/A	N/A
Cartridge with Carbon	51683	51684	51685
Filter Screen	N/A	N/A	N/A
CPF Main Body	N/A	N/A	N/A
Black Sponge	51683	51684	51685
Bottom Cover	N/A	N/A	N/A
Flow Adjusting Knob	51692	51693	51693

This product is guaranteed as free from defects in materials and workmanship for a period of 1 year from the date of purchase. This guarantee covers only any defects caused during normal use and operation of the filter, in accordance with the instructions enclosed.

It does not apply to any unauthorised modifications or misuse, improper or inadequate maintenance, or operations outside the product specifications. In case of defect within the stated warranty period, the product should be returned, with proof of purchase, to the point of purchase.

This guarantee does not affect your statutory rights. Guarantee service includes repair or replacement of the filter at Interpet Ltd.'s discretion. Neither Interpet nor the manufacturer are liable for any direct, indirect, special, incidental or consequential damages, including loss of livestock, arising from a defect in this product.

## GUARANTEE

## TROUBLESHOOTING

### Problem 1: CPF Flow rate drops considerably.

**Solution 1:** Check for blockages to the filter inlets. Ensure fibrous material such as plant matter has not formed an obstruction. Clean all pump intake cover and impeller cover – see 3 monthly care routine.

**Solution 2:** High flow internal filter with a built-in cartridge is designed specifically around easy access to replace, this means when the cartridge is fully blocked the flow rate will visibly decrease and will need replacing. See Getting to Know Your CPF Filter for cartridge replacement codes.

### Problem 2: CPF Filter is noisy

**Solution 1:** First, please be aware that operating the venturi will create unavoidable noise as air is forced into the water flow under pressure. If the noise is disturbing, the venturi can either be turned down or insert the air inlet stopper.

**Solution 2:** Check the impeller. The impeller should be carefully removed and cleaned using a soft cloth. A small brush or cloth may be inserted into the impeller chamber, removing debris inside. Once the impeller has been cleaned the magnet should be inspected for any damage such as cracks or pieces missing. If the impeller magnet is damaged in anyway, the impeller should be replaced.

### Problem 3: Air flow (venturi) slows or stops

**Solution 1:** Ensure the venturi airline is not submerged. It can only work if the venturi inlet is above the water surface.

**Solution 2:** Ensure there are no blockages in either the pump outlet or the venturi pipe. Venturi failure is usually caused by poor flow from the pump. This may be caused by either a blockage in the impeller chamber, or by blockages in the filter body. If the latter is the case, it is suggested that you clean the inside of the filter body, washing the foam thoroughly in aquarium water. If the foam and cartridge have lost their shape due to prolonged use, they will need replacing.

### Problem 4: Power cut

**Solution:** Any interruption of more than 2-3 hours of the water supply through the filter will cause the beneficial bacteria in the filter to begin to die off. Should this occur, do not simply re-start the filter. It is advised to clean all of the filter media and start the filter again. In an aquarium fully stocked with fish, this may lead to water quality problems. The filter should be seeded with a bacteria product such as Interpet Fast Filter Start. Regular checks should be made on the ammonia levels - using Interpet Complete Aquarium Dip Test Kit, if they reach detectable levels, we would recommend the use of Interpet Ammonia Remover.

### Problem 5: Water will not stay crystal clear

**Solution:** If the aquarium does not contain large, messy fish you may consider using Interpet Quick Clear which clumps fine particles together, allowing the filter media to remove it more effectively. Additionally it may be worth considering reducing feeding levels for 2-3 days and ensure you are performing regular water changes.

If you encounter an issue which is not documented here you should seek advice from the Interpet Customer Care department:

E-mail: [customercare@interpet.co.uk](mailto:customercare@interpet.co.uk)

### Filter Media

Three month service packs available for your internal cartridge filter.  
Product codes: 51683, 51684 & 51685



### Bioactive Tapsafe Plus

A unique and advanced formulation developed in conjunction with global leaders in Biotechnology. It removes chlorine, chloramines and heavy metals and this in turn even allows hot tap water to be used as part of a water change mix. An Aloe Vera protective colloid within Tapsafe creates a barrier around the fish's delicate skin and gill membranes. As an added feature it also adds a culture of bacteria and enzymes that consume any excess biological waste in the aquarium and boosts filter performance.  
Product code: 55555



### Aquarium Dip Test Kit

Quick and easy water testing  
Essential tests for:  
• Ammonia • Nitrite • Nitrate  
• pH • Water hardness (KH & GH)  
Product code: 55112



Interpet Ltd., Vincent Lane, Dorking, Surrey, RH4 3YX, England  
Email: [customercare@interpet.co.uk](mailto:customercare@interpet.co.uk) [facebook.com/interpet](https://www.facebook.com/interpet)

[www.interpet.co.uk](http://www.interpet.co.uk)

SAVE THESE INSTRUCTIONS



This symbol on the product or on its packaging indicates that the product must not be disposed of with normal household waste. Instead, it is your responsibility to dispose of your waste equipment by arranging return to a designated collection point for the recycling of waste electrical and electronic equipment. By separating and recycling your waste equipment at the time of disposal you will help to conserve natural resources and ensure that the equipment is recycled in a manner that protects human health and the environment. For more information about recycling the product, please contact your local city office, your household waste disposal service or the shop from where you purchased the product.

Disposal of used Electrical and Electronic Equipment (applicable in the European Union and other European countries with separate collection systems):

This is for indoor use only – do not use outside. Do not use this unit if the cable or plug are damaged or appear to be malfunctioning, or if it dropped or damaged in any manner. Do not use if the plug gets wet. Refer to section 3. Installing your filter, to find out how to create a drip loop. Dispose of responsibly following instructions from your local authority. Close supervision is necessary when any appliance is used by or near children. Do not install or store the appliance where it will be exposed to the weather or to temperatures below freezing point. If an extension cord is necessary, a cable rated with a proper rating should be used. A cable rated for less amperes or watts than the appliance rating may cause the product to overheat. Care should be taken to arrange the cable so that it will not be tripped over or pulled.

**WARNING:** To guard against injury, basic safety precautions should be observed, including the following guidelines:  
**DANGER:** To avoid possible electric shock, special care should be taken since water is employed in the use of aquarium equipment. For each of the following situations, do not attempt repair yourself, return the appliance to an authorised service facility for servicing, or discard the appliance.

READ AND FOLLOW ALL SAFETY INSTRUCTIONS

## IMPORTANT SAFEGUARDS



# Corner Power Filter

CPF1, CPF2 and CPF3

## Quick Start Guide



## LIFE SUPPORT

FOR COLDWATER OR TROPICAL AQUARIUMS